

# DEVICEMASTER RTS 1-PORT MECHANICAL DIMENSION DRAWING

REVISION RECORD					
REV	ECO	DESCRIPTION	DATE	DRFT	APVD
A	5484	Initial Release	10/22/02	SJL	

NOTES:

1. RECOMMENDED VERTICAL MOUNTING ORIENTATION IS AS SHOWN, WITH DB9 CONNECTOR AT BOTTOM.

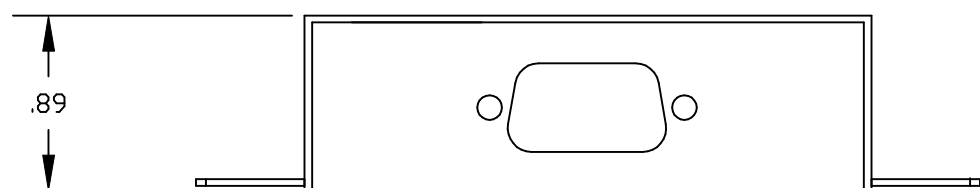
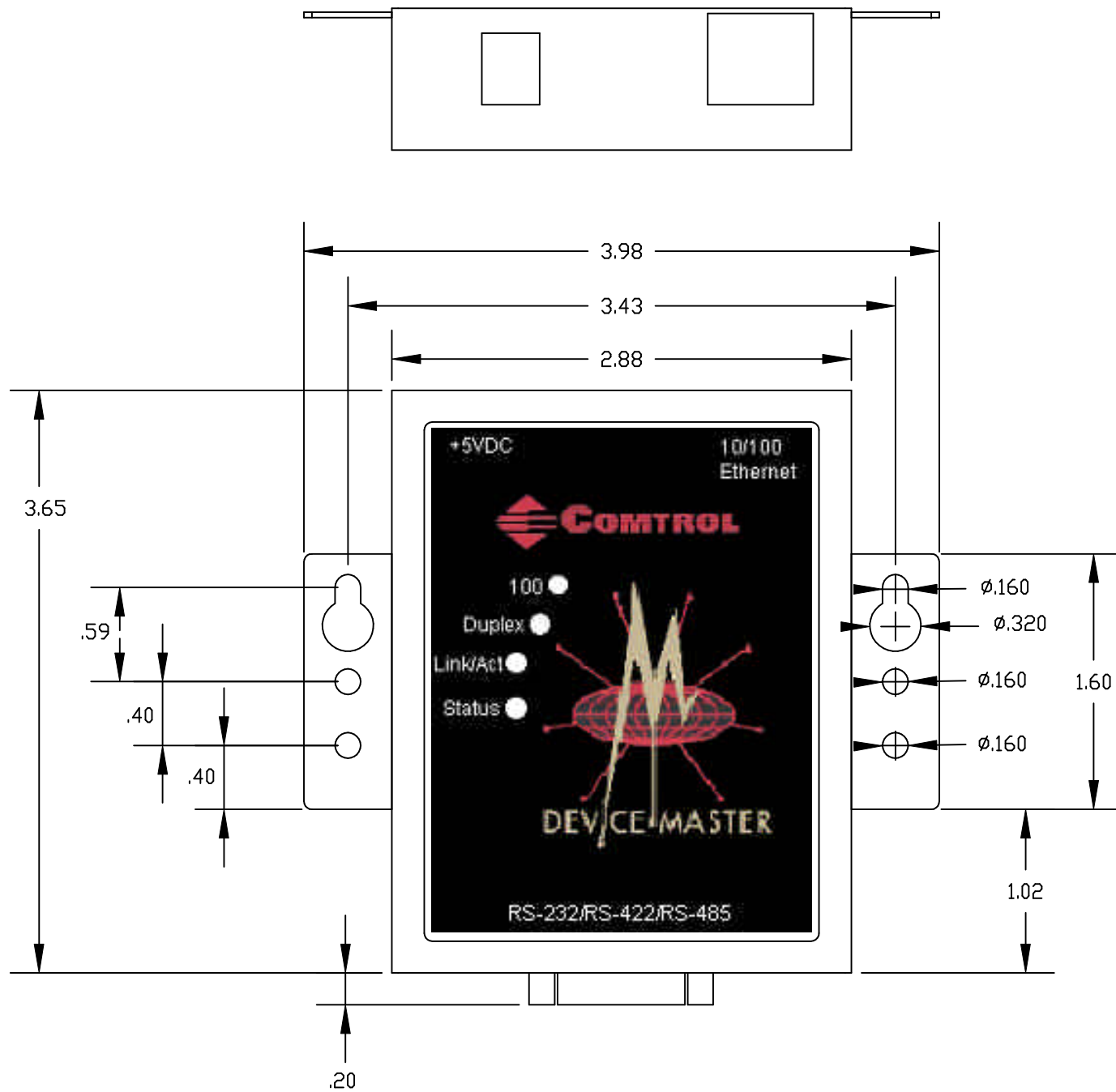

<p><b>PROPRIETARY DATA</b></p> <p>THE INFORMATION AND DESIGN DISCLOSED HEREIN ARE THE PROPERTY OF CONTROL CORPORATION AND MAY NOT BE REPRODUCED OR DISCLOSED IN ANY FORM WITHOUT THE WRITTEN CONSENT OF CONTROL CORPORATION. THE FOREGOING DOES NOT APPLY TO VENDOR PROPRIETARY PARTS.</p>	<p>UNLESS OTHERWISE SPECIFIED, DIMENSIONS ARE IN INCHES.</p>			<p> CONTROL CORP.™</p>			
	<p>TOLERANCES</p>			<p>TITLE: SPEC MECH DVCMSTR RTS 1P</p>			
	.00	.000	ANGLES	SIZE B	BY SJL	FILENAME 9000386A.DWG	DATE 10/22/02
	±.02	±.005	± 1°	P/N 9000386	REV A	SHEET 1 OF 1	