

IO EXPANSION HUB FAMILY



Control IO-Link Block family provides a selection of models to connect Analog (Voltage and Current Input) and Digital sensors and/or Actuators through IO-Link:

- Analog Input (M12 connectors)
- Analog Input/output (M12 connectors)
- Digital Input (M8 or M12 connectors)
- Digital Output (M8 or M12 connectors)
- Digital Input/Output (M8 or M12 connectors)

The Control IO-Link Block family is designed according to IO-Link specification V1.1 and the range of the connection is 20 M in accordance with the IO-Link specification. Since the IO-Link Block family are IO-Link devices, they can be identified, configured, and diagnosed. You can implement data storage and if necessary, easily replace the IO-Link Block without needing parameterization.

See the table below for available models.

Product Model	Product Description	Control Part Number
IOLB-7014	4 Channel Analog Input IO-Link Block with M12 connectors (Class B)	99640-8
IOLB-7214	4 Channel I/O Block Analog I/O with M12 connectors (Class B)	99643-9
IOLB-8008	8 Point I/O Block Digital Input with M8 connectors (Class A)	99645-3
IOLB-8018	8 Point I/O Block Digital Input with M12 connectors (Class A)	99647-7
IOLB-8108	8 Point I/O Block Digital Output with M8 connectors (Class B)	99650-7
IOLB-8118	8 Point I/O Block Digital Output with M12 connectors (Class B)	99652-1
IOLB-8308	8 Point I/O Block Digital I/O with M8 connectors (Class B)	99655-2
IOLB-8318	8 Point I/O Block Digital I/O with M12 connectors (Class B)	99657-6

Conventional Analog/Digital Cards and Wiring

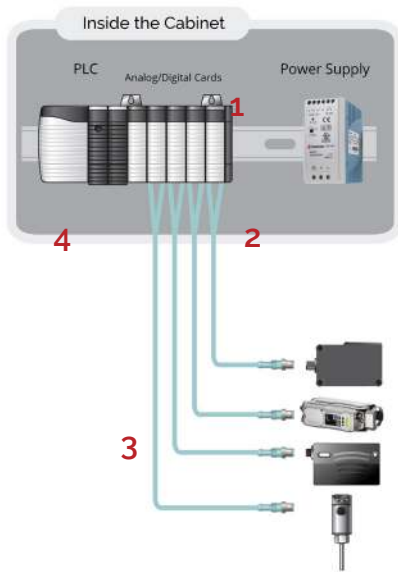

1. More cabinet space occupied by PLC cards which add cost per point
2. Sensor wiring and terminations take up space, time and add cost
3. Cabling to sensors becomes more expensive the further you go from the cabinet
4. Sensors only connect to one protocol directly

CONTROL® I/O Expansion System

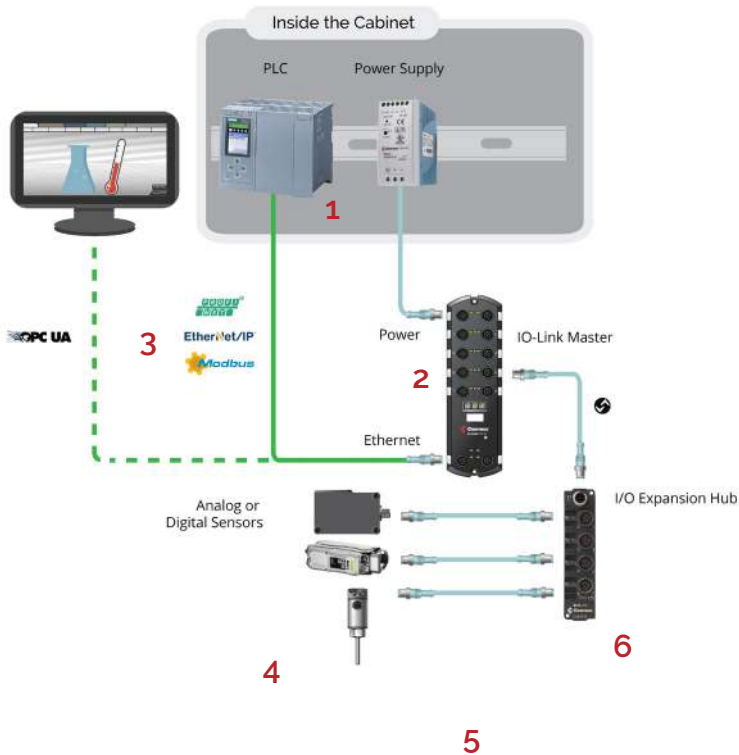

1. Only two cables are brought into the cabinet (Power and Ethernet)
 - commission cabinet faster, reduce wiring, reduce human error
 - valuable cabinet space is saved
2. IO-Link master can connect up to 8 expansion hubs, 16 sensor connections, or combination
3. IO-Link master can send data to multiple controllers and use multiple protocols (Multi-Link)
 - No PLC required
4. Sensors are connected at the application site which reduces cabling costs
5. Shorter cable lengths improve noise immunity for analog devices
6. Expansion hubs are intelligent IO-Link devices and connect analog or digital I/O to the IO-Link Master

CONTACT AND SUPPORT INFORMATION

Warranty Information

Control offers a 30-day satisfaction guarantee and 5-year limited warranty.

Sales Support

+1.763.957.6000
sales@control.com

Technical Support

+1.763.957.6000
www.control.com/support

Email, FTP, and Web Support

info@control.com
ftp.control.com
www.control.com